

## Before You Buy That “Low Cost” Health Insurance: Know What You’re Buying. Get Advice from a Trusted Source.

**Open Enrollment to purchase health insurance through the Maryland Health Connection for 2021 coverage is from November 1 to December 15.** You may still be able to enroll in comprehensive coverage outside of these dates if you have a qualifying life event, like losing other health coverage, moving, getting married, or having a child. Medicaid is always open to those who qualify.

### **Financial Help May Be Available**

If you purchase a policy through the Maryland Health Connection, financial help (such as tax credits, premium subsidies, and cost sharing) may be available to you. Visit the Maryland Health Connection at: <https://www.marylandhealthconnection.gov/> to learn if you qualify for financial help, or if you qualify for low- or no-cost coverage through Medicaid.

You can find navigators and insurance producers (agents or brokers) qualified to review plans at the Maryland Health Connection: <https://www.marylandhealthconnection.gov/>.

To buy insurance that will cover a wide range of conditions, start with the Maryland Health Connection: <https://www.marylandhealthconnection.gov/> or talk to an insurance producer (agent or broker) that is licensed in Maryland. If you have questions, call the Maryland Insurance Administration at 800 492-6116.

**If you are looking to buy a new health plan to save money,** here are some questions you may want to ask before you buy. For help, call the Maryland Insurance Administration at 800-492-6116:

- Is it a Short-Term, Limited Duration plan, a Sharing Ministry plan, or other limited-coverage plan? If so, the plan may offer limited benefits and/or may not be regulated by the State of Maryland.
- Is it sold through an association that requires a membership fee? If so, it could cover less than Maryland Health Connection plans.
- Is the person selling the plan licensed in Maryland? If so, ask for his/her state license number and call the Maryland Insurance Administration at 800 492 – 6116 to confirm.
- Who is the carrier and is it licensed in Maryland?
- Does the plan cover your pre-existing conditions? Does it cover your medications?
- What are the deductibles? There may be different deductibles for different services.
- What services DOESN'T the plan cover?
- For services that ARE covered, how much will the plan actually pay? Is there a limit on the total amount the plan will pay per person, per service, or per year?
- How long will the coverage last? Will you be able to keep or renew your coverage if you get sick?
- Does the plan have a provider network?
  - If yes, how do you access information about it? Is your doctor or hospital in the network?
  - If not, will you have to pay any part of the provider's fees?

You can also ask for a written example of how coverage works if you visited a physician and needed diagnostic tests and follow-up care, or had a hospital stay for several days, and had testing and scans, surgery, and saw several specialists.

Before you buy, it is a good idea to always ask for the plan's details in writing and take the time to review the materials carefully. Don't feel rushed to make a decision. Remember, there is free help available to you. You can call the Maryland Insurance Administration at 1-800-492-6116.

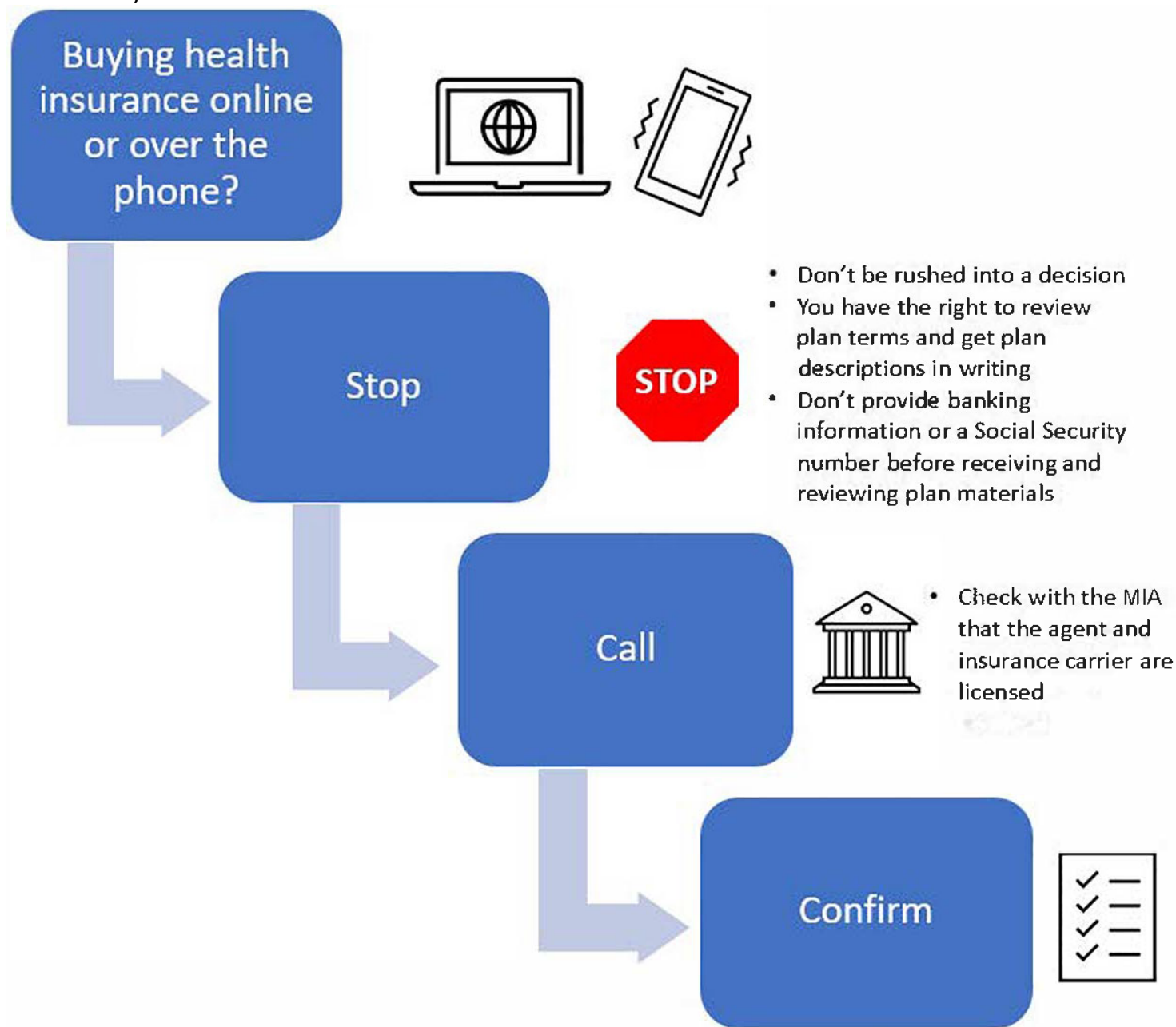

Be sure to get coverage information in writing *before* you buy. It is a good idea to ask about:

- Coverage of key benefits like prescription drugs and preventive care
- Coverage limits per service, per person, or per year
- Coverage for conditions you already have (pre-existing conditions)
- The amount you pay before the plan pays (deductible)

Get more help with these resources from the Maryland Insurance Administration:

[What to Ask When Shopping for Health Insurance](#)

[Know The Details When You Shop for Health Insurance Coverage](#)

This consumer guide should be used for educational purposes only. It is not intended to provide legal advice or opinions regarding coverage under a specific insurance policy or contract; nor should it be construed as an endorsement of any product, service, person, or organization mentioned in this guide. Please note that policy terms vary based on the particular insurer and you should contact your insurer or insurance producer (agent or broker) for more information.

This publication has been produced by the Maryland Insurance Administration (MIA) to provide consumers with general information about insurance-related issues and/or state programs and services. This publication may contain copyrighted material which was used with permission of the copyright owner. Publication herein does not authorize any use or appropriation of such copyrighted material without consent of the owner.

All publications issued by the MIA are available free of charge on the MIA's website or by request. The publication may be reproduced in its entirety without further permission of the MIA provided the text and format are not altered or amended in any way, and no fee is assessed for the publication or duplication thereof. The MIA's name and contact information must remain clearly visible, and no other name, including that of the insurer or insurance producer reproducing the publication, may appear anywhere in the reproduction. Partial reproductions are not permitted without the prior written consent of the MIA.

**Persons with disabilities may request this document in an alternative format. Requests should be submitted in writing to the Director of Communications at the address listed below.**



# Maryland

**INSURANCE ADMINISTRATION**

200 St. Paul Place, Suite 2700

Baltimore, MD 21202

410-468-2000

800-492-6116

800-735-2258 TTY

[www.insurance.maryland.gov](http://www.insurance.maryland.gov)

[www.facebook.com/MdInsuranceAdmin](https://www.facebook.com/MdInsuranceAdmin)

[www.twitter.com/MD\\_Insurance](https://www.twitter.com/MD_Insurance)

[www.instagram.com/marylandinsuranceadmin](https://www.instagram.com/marylandinsuranceadmin)